

Straight Female Couplings

GAI-M

Dimensions in mm

DIN Fittings

Metric Tube end as per ISO 8434

Female Metric (M) threads

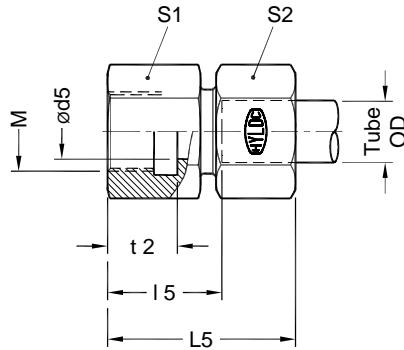

*

Part No.	Series	Tube od	M	$\phi d5$	t 2	I 5	L 5	S 1	S 2
GAI06PLM	Light L 250 bar	6	M10 x 1.0	4	12.5	19.5	35.0	14	14
GAI08PLM		8	M12 x 1.5	6	17	24.0	39.0	17	17
GAI10PLM		10	M14 x 1.5	8	17	25.0	40.5	19	19
GAI12PLM		12	M16 x 1.5	10	17	26.0	41.0	22	22
GAI15PLM		15	M18 x 1.5	12	17	28.0	44.0	24	27
GAI18PLM	160 bar	18	M22 x 1.5	15	19	29.5	46.5	30	32
GAI22PLM		22	M26 x 1.5	19	21	34.5	51.5	32	36
GAI28PLM	100 bar	28	M33 x 2.0	24	24	37.5	55.5	41	41
GAI35PLM		35	M42 x 2.0	30	26	40.5	63.5	55	50
GAI42PLM		42	M48 x 2.0	36	28	42.0	65.5	60	60
GAI06PSM	Heavy S 630 bar	6	M12 x 1.5	4	17	26.0	41.5	17	17
GAI08PSM		8	M14 x 1.5	5	17	26.0	41.0	19	19
GAI10PSM		10	M16 x 1.5	7	17	26.5	43.5	22	22
GAI12PSM		12	M18 x 1.5	8	17	27.5	44.0	24	24
GAI16PSM	400 bar	16	M22 x 1.5	12	19	30.5	49.5	30	30
GAI20PSM		20	M27 x 2.0	16	22	34.5	57.0	36	36
GAI25PSM		25	M33 x 2.0	20	24	37.0	62.0	41	46
GAI30PSM	250 bar	30	M42 x 2.0	25	26	41.5	69.5	55	50
GAI38PSM		38	M48 x 2.0	32	28	43.0	74.5	60	60

* Dimensions given are approx figures with tightened nut.